

MAISON LINEA

DESIGNERS

# Les Découvertes

ATELIER [CERAMIC EXPERT]



**Artoria**  
LIMOGES  
/ MANUFACTURE CRÉATIVE  
D'OBJETS PORCELAINE

## Exploring once more this noble and delicate material

---

‘La Porcelaine de Limoges’ was born from the casual discovery of a kaolin deposit around Limoges in 1765. It opened the way to new expression fields. This easy to mould material rapidly gained a reputation for excellence. Each complex and unique item is real goldsmith work and entirely handmade.

The industrial revolution brought its lot of innovations and modernity which enabled porcelain manufactures to open to international markets. Reserved to Parisian elite in the first place, Limoges Porcelain was renewed; output was improved while preserving an unequalled level of quality and requirement.

‘La Porcelaine de Limoges’ obviously went a few setbacks after the two world wars but it always recovered thanks to its manufactures which were aware of the fact that design is an innovation motor and generates value. In the 50s, they were updated notably through designers like Raymond Loewy, Roger Tallon, Marc Held, Andrée Putman...

Nevertheless, since the 80s, consumer habits have evolved and popularity has decreased... To be successful again Limoges Porcelain needs to renew itself one more time. That is what we are starting to do with ARTORIA Manufacture in developing new porcelain items meant for spirit drinks.

TEASER LES DÉCOUVERTES | ATELIER - CERAMIC EXPERT

## MODERNIZATION OF PORCELAIN

COLLABORATION



We are brand expert and packaging designers for wines and spirits since 1979 and we guarantee know-how over several decades. Our culture, our sensitivities and our personalities enable us to claim a unique expertise and talk about our profession in an innovating and distinctive way. We support our customers' projects throughout the world. Passion inspires our creativity.



As an outstanding manufacture for Limoges Porcelain luxury products, we are the specialist for original and sophisticated containers ranging from perfume bottles and candle pots to Cognac carafes. Thanks to our 90 years of experience, we know the chemistry and the gestures that turn earth into uniquely white and delicate ceramics. We are certified by the prestigious EPV label (Entreprise du Patrimoine Vivant).

MAISON LINEA  
DESIGNERS



## Fine and translucent ceramics,

PORCELAIN OWES ITS PHYSICAL PROPERTIES TO ITS UNIQUE COMPONENTS. THREE NATURAL ROCKS ARE THUS ASSEMBLED, DILUTED IN WATER, GROUND, SIFTED AND FILTERED TO MAKE A MORE OR LESS LIQUID PASTE.





## MODERNIZATION OF PORCELAIN

### TECHNIQUE

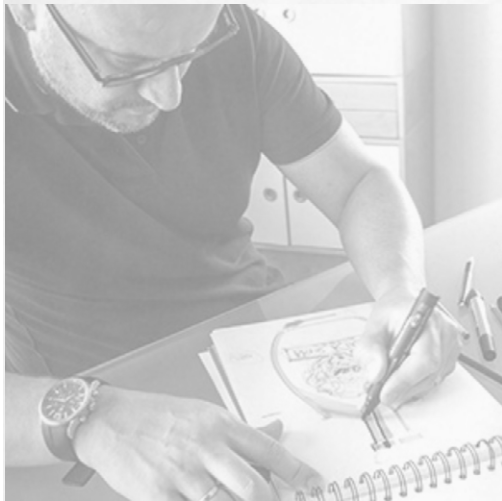

**01. Sketching** // From an idea or a concept #LineaDesigners come up with new carafe and bottle standards in the world of spirit drinks.

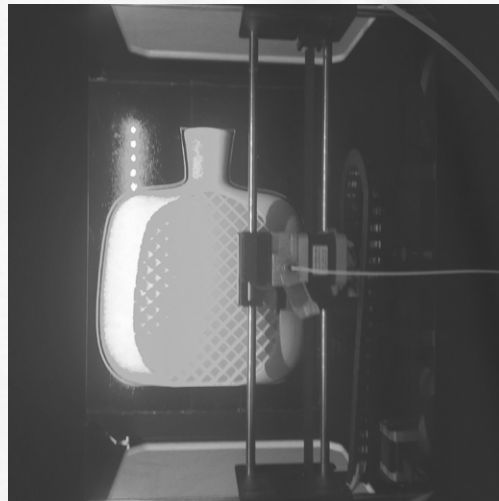

**02. Mould and model creation** // From 3D sketching, #Artoria modelling makes a plaster volume to obtain the first mould and the core that will be used for making production moulds.



**03. Pouring** // It consists in pouring the porcelain paste, into a plaster mould to make hollow items. Once the wanted thickness has been reached, the mould is overturned to empty the paste surplus. The item must harden before demoulding.



**04. Finishing** // It enables to remove the «seams» on the items caused by the splitting of the mould and to eliminate any other kind of flaws. A steel blade and then mild abrasive are used to polish the object. A wet paintbrush and a sponge are then used for the finishing touch.



**05. Drying** // It is the time during which the room is stored in the restroom to evacuate naturally its moisture.



**06. Initial firing** // The shaped, finished and dried items undergo a first 980° firing. It is called initial firing. It enables to obtain items that cannot be diluted, are more mechanically resistant with a maximal porosity.



**07. Enamelling** // Porcelain enamel is feldspar and limestone glass. It is a polish that is baked at the same temperature as the paste it lies on. The item is then plunged into an enamel bath.



**08. High firing** // At 1400°C, it vitrifies the paste and the enamel to make the porcelain whiter, more solid and translucent. The paste is brought to a partial fusion and the enamel to a total fusion.



**09. Decoration of the items** // Hand painted depending on the complexity of the components. In other cases a chromo (decalcomania) is applied by hand.

TEASER LES DÉCOUVERTES | ATELIER - CERAMIC EXPERT

CREATIONS

COLLECTION

# PORCELAINE

## COLLECTION



LIMOGES



TEASER LES DÉCOUVERTES | ATELIER - CERAMIC EXPERT

CREATIONS

AMBIX

AMBIX

PORCELAINE DE LIMOGES





CREATIONS

AMBIX

TECHNICALITY

DENSITY

LINEARITY

HANDCRAFTED

GEOMETRY

PRECISION

Volume/ 70cl -75cl

Weight/ 580g (±50g)

Hight/ 195mm

Diameter/ 93,7mm

PREMIUM



AMBIX

PORCELAINE DE LIMOGES

AMBIX which is inspired by the art of distillation reinterprets the curves of the alembic. Its simple and straight design stands out through its taut lines overlooking its cylindrical base. Its main feature is a square and strict shoulder marked by a slight clearance zone.

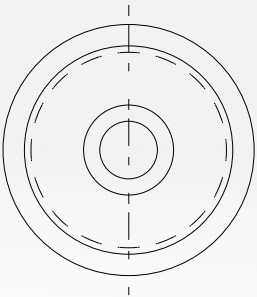



TEASER LES DÉCOUVERTES | ATELIER - CERAMIC EXPERT

CREATIONS

CODEX

PORCELAINE  
**CODEX**  
DE LIMOGES





CREATIONS

CODEx

PHARMACY  
◇◇◇◇◇  
MAGNIFICENCE  
◇◇◇◇◇  
ELEVATION  
◇◇◇◇◇  
PRESTIGE  
◇◇◇◇◇  
CONICITY  
◇◇◇◇◇  
STYLE

Volume/ 70cl -75cl	Weight/ 580g (±50g)
Hight/ 230mm	Diameter/ 94,5mm

PREMIUM



◇ CODEx is a neo retro reinterpretation of the old pharmacy bottles. The bottle is stylish and plain. It is conical on a curved body. Its tall design concept imposes magnificence and standing.

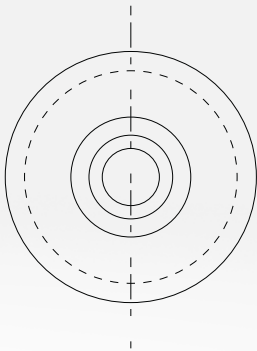

TEASER LES DÉCOUVERTES | ATELIER - CERAMIC EXPERT

CREATIONS

IKSIR

IKSIR

PORCELAINE DE LIMOGES





CREATIONS

IKSIR

GENEROSITY

-----

DENSITY

-----

OPULENCE

-----

ROUNDNESS

-----

LABORATORY

-----

CRAFTED

**Volume/** 70cl -75cl

**Weight/** 580g (±50g)

**Hight/** 182mm

**Diameter/** 100mm

PREMIUM



IKSIR

PORCELAINE DE LIMOGES

IKSIR revisits the design of pharmacy jugs through a decidedly modern creation. Its compact and generous shape is characterized by a round shoulder. Its cylindrical and harmonious curves are part of its laboratory and crafted perception.

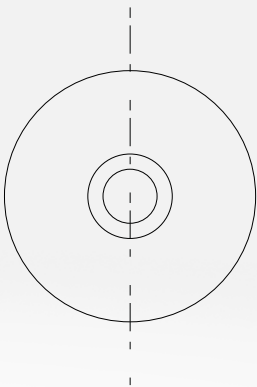



TEASER LES DÉCOUVERTES | ATELIER - CERAMIC EXPERT

CREATIONS

CANDIDE

*Candide*

PORCELAINE DE LIMOGES





## CREATIONS

### CANDIDE

SUPPLENESS



FLUIDITY



LIGHTNESS



GENEROSITY



SIMPLICITY



RELAXING

**Volume/** 70cl-75cl

**Weight/** 580g (±50g)

**Hight/** 198,9mm

**Width/** 164mm

**Thickness/** 53mm

ULTRA PREMIUM



*Candide*

PORCELAINE DE LIMOGES

CANDIDE 's simple design stands out through its soft and light concept. Like a jug, the bottle displays a thin contour with smooth and generous curves. Its short flaring neck gives it elegance and modernity.

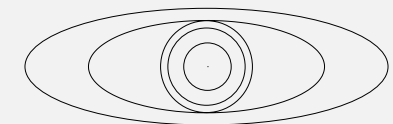

TEASER LES DÉCOUVERTES | ATELIER - CERAMIC EXPERT

CREATIONS

OPUS

OPUS

PORCELAINE DE LIMOGES





DELICACY



ELEGANCE



TRADITION



ELEVATION



BRIGHT & SHARP



MAGNIFICENT

**Volume/** 70cl-75cl

**Weight/** 580g (±50g)

**Hight/** 211mm

**Width/** 157mm

**Thickness/** 57mm

ULTRA PREMIUM



# OPUS

PORCELAINE DE LIMOGES

OPUS is a formal and radiant bottle with an impressive natural style. Its distinctive and unique shape unveils accentuated edges – a specific feature to chinaware. Its magnificent design allies timelessness and tradition.

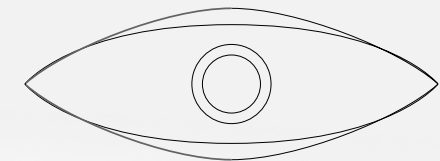

One team  
One dream



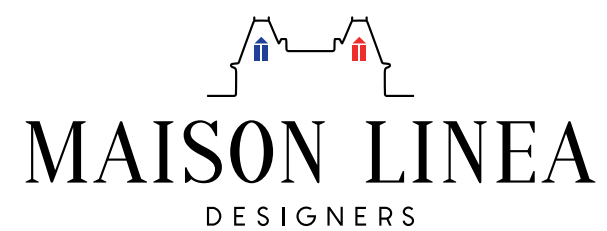

MAISON LINEA | 23 place Jean Monnet | 16100 COGNAC | France  
Tel. : +33 (0)5 45 92 83 83 | WhatsApp : +33(0)7 70 25 19 13 | [we@linea.design](mailto:we@linea.design)  
[www.linea.design](http://www.linea.design) | [f](#) [t](#) [in](#) [Be](#) [p](#) [@](#)